

DO NOT SCALE FROM THIS DRAWING FOR CONSTRUCTION PURPOSES

THIS COPY HAS BEEN MADE BY OR WITH THE AUTHORITY OF RYEDALE DISTRICT COUNCIL PURSUANT TO SECTION 47 OF THE COPYRIGHT DESIGNS AND PATENTS ACT 1988. UNLESS THAT ACT PROVIDES A RELEVANT EXCEPTION TO COPYRIGHT, THE COPY MUST NOT BE COPIED WITHOUT THE PRIOR PERMISSION OF THE COPYRIGHT OWNER.

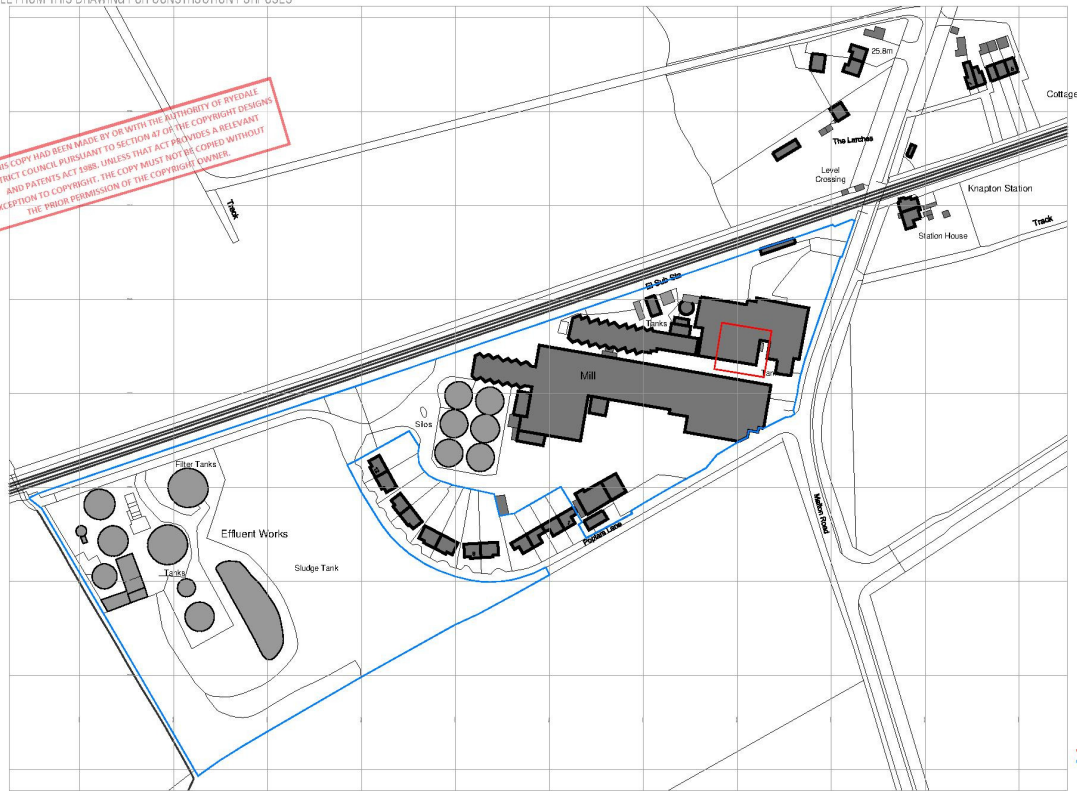

DATE VALID
02/04/15

General Notes
 Site boundary: 47539.1m² (approx)
 Secondary boundary: 11.75 acres, 4.75 hectare

General Arrangement _ Os Map _ 1 : 2500

Status: PLANNING		Job Title: Location / Os Map		Map Title: Boortmalt Group Knapton Maltings, Knapton Malton, North Yorkshire, YO17 6RN Roaster Project		Client: BOORTMALT		Client: Gelder and Kitchen LLP CONSTRUCTION CONSULTANTS Malton House, 100 High Street, Knapton Open Hall, YO1 1RL T: +44 (0)1662 204114 www.gelderandkitchen.co.uk	
Job No: 13/209	Code: AA	Sheet: 100	Date: 001	Date:	Description:	Date:	Drawn by:	Checked:	Scale: 1 : 2500
REVISIONS									